

PROJECT NO.	SHEET NO.	TOTAL NO.
2022CPT.08.16.20762	1a	

SUMMARY OF QUANTITIES

PROJECT NO	COUNTY	MAP NO	ROUTE	DESCRIPTION	TYP NO	LANES	LANE TYPE	FINAL SURFACE TESTING REQUIRED	WARM MIX ASPHALT REQUIRED	LENGTH	WIDTH	1704000000-E	1803500000-E	1820000000-E	1838000000-E	1838500000-N	2143000000-E
												PATCHING EXISTING PAVEMENT	ASPHALT SURFACE TREATMENT, DOUBLE SEAL	ASPHALT SURFACE TREATMENT, FOG SEAL	EMULSION FOR ASPHALT SURFACE TREATMENT	VACUUM TRUCK	BLOTTING SAND
												TONS	SY	SY	GAL	WK	TON
2022CPT.08.16.20762	Randolph	1	SR 1419 LOWE COUNTRY RD	(FROM: SR 1418 SPENCER MEADOW RD. TO: US HWY 64 W)	1	2	2WU	NO	NO	0.63	20	20	7,393.00		4,066		
TOTAL FOR MAP NO. 1												20	7,393.00		4,066		
2022CPT.08.16.20762	Randolph	2	SR 1418 SPENCER MEADOW RD.	(FROM: US HWY 64 W TO: SR 1416 OLD LEXINGTON RD.)	1	2	2WU	NO	NO	1.27	20	40	14,902.00		8,196		
TOTAL FOR MAP NO. 2												40	14,902.00		8,196		
2022CPT.08.16.20762	Randolph	3	SR 1493 REFLECTION LN.	(FROM: SR 1492 HARMONY TRL. TO: END-OF-CUL-DE-SAC)	2	2	2WU	NO	NO	0.05	20	40	587.00	587.00	323		
TOTAL FOR MAP NO. 3												40	587.00	587.00	323		
2022CPT.08.16.20762	Randolph	4	SR 1492 HARMONY TRAIL	(FROM:SR 1418 SPENCER MEADOW RD. TO: END OF CUL-DE-SAC)	2	2	2WU	NO	NO	0.16	20	100	1,878.00	1,878.00	1,033		
TOTAL FOR MAP NO. 4												100	1,878.00	1,878.00	1,033		
2022CPT.08.16.20762	Randolph	5	SR 1494 TRANQUIL LN.	(FROM:SR 1418 SPENCER MEADOW RD. TO: END OF CUL-DE-SAC)	2	2	2WU	NO	NO	0.19	21	20	2,343.00	2,343.00	1,288		
TOTAL FOR MAP NO. 5												20	2,343.00	2,343.00	1,288		
2022CPT.08.16.20762	Randolph	6	SR 3144 BENTON RD.	(FROM:SR 1518 PLAINFIELD RD. TO: END OF MAINTENANCE)	2	2	2WU	NO	NO	0.23	18	20	6,288.00	6,288.00	3,458		
TOTAL FOR MAP NO. 6												20	6,288.00	6,288.00	3,458		
2022CPT.08.16.20762	Randolph	7	SR 1514 OLD WAY RD.	(FROM: END-OF-STATE MAINTENANCE TO: SR 1518 PLAINFIELD RD.)	2	2	2WU	NO	NO	0.31	20	50	3,638.00	3,638.00	2,001		
TOTAL FOR MAP NO. 7												50	3,638.00	3,638.00	2,001		
2022CPT.08.16.20762	Randolph	8	SR 3225 SYLVAN WAY	(FROM: SR 1518 LAKE LUCAS RD. TO: END-OF-CUL-DE-SAC)	2	2	2WU	NO	NO	0.25	20	50	2,933.00	2,933.00	1,613		
TOTAL FOR MAP NO. 8												50	2,933.00	2,933.00	1,613		
2022CPT.08.16.20762	Randolph	9	SR 3226 BLUEBIRD LN.	(FROM:SR 3225 SYLVAN WAY TO: END OF CUL-DE-SAC)	2	2	2WU	NO	NO	0.16	20	50	1,878.00	1,878.00	1,033		
TOTAL FOR MAP NO. 9												50	1,878.00	1,878.00	1,033		
2022CPT.08.16.20762	Randolph	10	SR 2120 CAMP NAWAKA RD.	(FROM:SR 2119 NAOMI RD. TO:END OF MAINTENANCE)	2	2	2WU	NO	NO	0.31	20	20	3,637.00	3,637.00	2,001		
TOTAL FOR MAP NO. 10												20	3,637.00	3,637.00	2,001		
2022CPT.08.16.20762	Randolph	11	SR 2328 LAUREL LN.	(FROM:SR2120 CAMP NAWAKA RD. TO:END OF MAINTENANCE)	2	2	2WU	NO	NO	0.09	20	20	1,058.00	1,058.00	582		
TOTAL FOR MAP NO. 11												20	1,058.00	1,058.00	582		
2022CPT.08.16.20762	Randolph	12	SR 2828 MILES MOFFITT RD.	FROM NC 42 TO END OF MAINTENANCE	2	2	2WU	NO	NO	0.84	20	60	9,858.00	9,858.00	5,422		
TOTAL FOR MAP NO. 12												60	9,858.00	9,858.00	5,422		
2022CPT.08.16.20762	Randolph	13	SR 2986 KEN LEE CT.	(FROM:SR 2828 MILES MOFFITT RD. TO: END OF CUL-DE-SAC)	2	2	2WU	NO	NO	0.2	20	20	2,347.00	2,347.00	1,291		
TOTAL FOR MAP NO. 13												20	2,347.00	2,347.00	1,291		
2022CPT.08.16.20762	Randolph	14	SR 1206 CANNON HEIGHTS DR.	(FROM:SR 1144 MACK RD.TO: END OF CUL-DE-SAC)	2	2	2WU	NO	NO	0.19	20	20	2,231.00	2,231.00	1,227		
TOTAL FOR MAP NO. 14												20	2,231.00	2,231.00	1,227		
2022CPT.08.16.20762	Randolph	15	SR 1252 SOUTHMONT HEIGHTS AVE.	(FROM:SR 1206 CANNON HEIGHTS DR. TO:END OF MAINTENANCE)	2	2	2WU	NO	NO	0.13	20	20	1,409.00	1,409.00	775		
TOTAL FOR MAP NO. 15												20	1,409.00	1,409.00	775		
2022CPT.08.16.20762	Randolph	16	SR 1253 MONTLEY VIEW DR.	(FROM:SR 1252 SOUTHMONT HEIGHTS AVE. TO: END OF MAINTENANCE)	2	2	2WU	NO	NO	0.13	20	20	1,527.00	1,527.00	840		
TOTAL FOR MAP NO. 16												20	1,527.00	1,527.00	840		
2022CPT.08.16.20762	Randolph	17	SR 3002 FAITH MEADOWS LN.	(FROM: NC159 TO: END OF CUL-DE-SAC)	2	2	2WU	NO	NO	0.26	20	20	1,678.00	1,678.00	1,678		
TOTAL FOR MAP NO. 17												20	1,678.00	1,678.00	1,678		

														PROJECT NO.		SHEET NO.	TOTAL NO.
														2022CPT.08.16.20762		1b	
2022CPT.08.16.20762	Randolph	18	SR 2978 NORTH POINTE DR.	(FROM:SR 2976 TWIN CREEK RD. TO: END-OF-MAINTENANCE)	2	2	2WU	NO	NO	0.14	20	20	1,644.00	1,644.00	904		
TOTAL FOR MAP NO. 18										0.14	20	20	1,644.00	1,644.00	904		
2022CPT.08.16.20762	Randolph	19	SR 2976 TWIN CREEK RD.	(FROM: NC-159 TO: END OF CUL-DE-SAC)	2	2	2WU	NO	NO	0.28	20	20	3,287.00	3,287.00	1,808		
TOTAL FOR MAP NO. 19										0.28	20	20	3,287.00	3,287.00	1,808		
2022CPT.08.16.20762	Randolph	20	SR 2993 WILLOW DOWNS CT.	(FROM: NC 159 TO: END OF CUL-DE-SAC)	2	2	2WU	NO	NO	0.2	20	20	2,349.00	2,349.00	1,292		
TOTAL FOR MAP NO. 20										0.2	20	20	2,349.00	2,349.00	1,292		
2022CPT.08.16.20762	Randolph	21	SR 3117 DOGWOOD TRL.	(FROM: SR 1408 HOOVER HILL RD. TO: SR 3116 FOREST LAKE DR.)	2	2	2WU	NO	NO	0.34	20	20	4,107.00	4,107.00	2,259		
TOTAL FOR MAP NO. 21										0.34	20	20	4,107.00	4,107.00	2,259		
2022CPT.08.16.20762	Randolph	22	SR 3116 FOREST LAKE DR.	(FROM: SR 3115 RED FOX TRL. TO: SR 3117 DOGWOOD TRL.)	2	2	2WU	NO	NO	0.18	20	20	2,113.00	2,113.00	1,162		
TOTAL FOR MAP NO. 22										0.18	20	20	2,113.00	2,113.00	1,162		
2022CPT.08.16.20762	Randolph	23	SR 3115 RED FOX TRL.	(FROM: SR1408 HOOVER HILL RD. TO: SR3116 FOREST LAKE DR.)	2	2	2WU	NO	NO	0.35	20	20	4,107.00	4,107.00	2,259		
TOTAL FOR MAP NO. 23										0.35	20	20	4,107.00	4,107.00	2,259		
2022CPT.08.16.20762	Randolph	24	SR 1434 DANWOOD ST.	(FROM: SR 3255 OLD FARMER RD. TO: SR 1433 BUNTING RD.)	2	2	2WU	NO	NO	0.35	20	20	4,107.00	4,107.00	2,259		
TOTAL FOR MAP NO. 24										0.35	20	20	4,107.00	4,107.00	2,259		
2022CPT.08.16.20762	Randolph	25	SR 1436 RUSHWOOD RD.	(FROM: SR 3255 OLD FARMER RD. TO: SR 1435 HIGHRIDGE ST.)	2	2	2WU	NO	NO	0.17	20	20	1,993.00	1,993.00	1,096		
TOTAL FOR MAP NO. 25										0.17	20	20	1,993.00	1,993.00	1,096		
2022CPT.08.16.20762	Randolph	26	SR 1435 HIGHRIDGE ST.	(FROM: SR 1437 RUSSELL ST. TO: END OF MAINTENANCE)	2	2	2WU	NO	NO	0.18	20	20	2,113.00	2,113.00	194		
TOTAL FOR MAP NO. 26										0.18	20	20	2,113.00	2,113.00	194		
2022CPT.08.16.20762	Randolph	27	SR 1433 BUNTING RD.	(FROM: SR 3255 OLD FARMER RD. TO: END OF MAINTENANCE)	2	2	2WU	NO	NO	0.9	20	20	10,560.00	10,560.00	5,808		
TOTAL FOR MAP NO. 27										0.9	20	20	10,560.00	10,560.00	5,808		
2022CPT.08.16.20762	Randolph	28	SR 1437 RUSSELL ST.	(FROM: SR 1434 DANWOOD RD. TO: END OF MAINTENANCE)	2	2	2WU	NO	NO	0.14	20	20	1,644.00	1,644.00	904		
TOTAL FOR MAP NO. 28										0.14	20	20	1,644.00	1,644.00	904		
2022CPT.08.16.20762	Randolph	29	SR 1438 NORMAN ST.	(FROM: SR 1437 RUSSELL ST. TO: END OF MAINTENANCE)	2	2	2WU	NO	NO	0.11	20	20	1,291.00	1,291.00	710		
TOTAL FOR MAP NO. 29										0.11	20	20	1,291.00	1,291.00	710		
2022CPT.08.16.20762	Randolph	30	SR 1439 HAMILTON ST.	(FROM: SR 1438 NORMAN ST. TO: END OF MAINTENANCE)	2	2	2WU	NO	NO	0.03	20	20	353.00	353.00	194		
TOTAL FOR MAP NO. 30										0.03	20	20	353.00	353.00	194		
2022CPT.08.16.20762	Randolph	31	SR 2408 BROWNS MEADOW RD.	(FROM: SR 1006 OLD 421 RD. TO: US HWY 421)	1	2	2WU	NO	NO	1.43	20	80	16,780.00		9,229		
TOTAL FOR MAP NO. 31										1.43	80	16,780.00		9,229			
2022CPT.08.16.20762	Randolph	32	SR 2408 BROWNS MEADOW RD.	(FROM: US HWY 421 TO: SR 2407 SHILOH RD)	1	2	2WU	NO	NO	0.26	20	50	3,204.00		1,762		
TOTAL FOR MAP NO. 32										0.26	50	3,204.00		1,762			
2022CPT.08.16.20762	Randolph	33	SR 2108 WAYNE WHITE RD	(FROM: SR 2116 NEW SALEM RD. TO: SR 2106 RACINE RD.)	1	2	2WU	NO	NO	3.11	20	150	36,491.00		20,070		
TOTAL FOR MAP NO. 33										3.11	150	36,491.00		20,070			
2022CPT.08.16.20762	Randolph	34	SR 2104 HOCKETT COUNTRY LN.	(FROM: GUILFORD COUNTY LINE. TO: SR 2103 WHITT HUNT RD.)	2	2	2WU	NO	NO	0.49	20	50	5,751.00	5,751.00	3,163		
TOTAL FOR MAP NO. 34										0.49	50	5,751.00	5,751.00	3,163			
2022CPT.08.16.20762	Randolph	35	SR 2360 TAYLOR WOODS LN.	(FROM: SR 2104 HOCKETT CTRY LN. TO: END OF CUL-DE-SAC)	2	2	2WU	NO	NO	0.23	20	50	2,700.00	2,700.00	1,485		
TOTAL FOR MAP NO. 35										0.23	50	2,700.00	2,700.00	1,485			
2022CPT.08.16.20762	Randolph	36	SR 2375 RAYLE FARM RD.	(FROM: SR 2360 TAYLOR WOODS LN. TO: SR 2103 WHITT HUNT RD.)	2	2	2WU	NO	NO	0.58	20	120	6,807.00	6,807.00	3,744		
TOTAL FOR MAP NO. 36										0.58	120	6,807.00	6,807.00	3,744			
2022CPT.08.16.20762	Randolph	37	SR 2102 BANTAM RD.	(FROM: GUILFORD COUNTY LINE. TO: SR 2101 BRANSON MILL RD.)	1	2	2WU	NO	NO	1.48	20	200	17,367.00		9,552		
TOTAL FOR MAP NO. 37										1.48	200	17,367.00		9,552			

														PROJECT NO.	SHEET NO.	TOTAL NO.					
														2022CPT.08.16.20762	1c						
2022CPT.08.16.20762	Randolph	38	SR 1306 RICHEY RD.	(FROM: SR 1303 BRANTLEY GORDON RD. TO: SR 1001 FARMER DENTON RD.)	1	2	2WU	NO	NO	1.88	20	150	22,060.00		12,133						
TOTAL FOR MAP NO. 38														1.88		150	22,060.00		12,133		
2022CPT.08.16.20762	Randolph	39	SR 1314 WOODS DAIRY RD / JACKSON CREEK RD.	(FROM: DAVIDSON COUNTY TO: SR 1311 BESCHER CHAPEL RD.)	1	2	2WU	NO	NO	3.46	20	200	40,598.00		22,329	15.00	25				
TOTAL FOR MAP NO. 39														3.46		200	40,598.00		22,329	15.00	25
2022CPT.08.16.20762	Randolph	40	SR 1343 CHAPELWOOD RD.	(FROM: SR 1314 WOODS DAIRY RD. TO: END OF MAINTENANCE)	1	2	2WU	NO	NO	0.5	20	60	5,867.00		3,227						
TOTAL FOR MAP NO. 40														0.5		60	5,867.00		3,227		
2022CPT.08.16.20762	Randolph	41	SR 1341 LOFLIN HILL RD.	(FROM: SR 1340 SUMMEY TOWN RD. TO: SR 1339 ROSS WOOD RD.)	1	2	2WU	NO	NO	1.94	20	100	22,764.00		12,520						
TOTAL FOR MAP NO. 41														1.94		100	22,764.00		12,520		
2022CPT.08.16.20762	Randolph	42	SR 1317 GOLDEN MEADOW RD.	(FROM: SR 1314 JACKSON CREEEK RD. TO: SR 1318 MOORE RD.)	1	2	2WU	NO	NO	1.84	20	100	21,591.00		11,875						
TOTAL FOR MAP NO. 42														1.84		100	21,591.00		11,875		
2022CPT.08.16.20762	Randolph	43	SR 2376 RAYLE FARM CT.	(FROM: SR 2375 RAYLE FARM RD. TO: END OF MAINTENANCE)	2	2	2WU	NO	NO	0.13	20	10	1,603.00	1,603.00	882						
TOTAL FOR MAP NO. 43														0.13		10	1,603.00	1,603.00	882		
TOTAL FOR PROJ NO. 2022CPT.08.16.20762														26.1		2,170	308,836.00	99,819.00	169,647	15.00	25
GRAND TOTAL														26.1		2,170	308,836.00	99,819.00	169,647	15.00	25

PROJECT NO.	SHEET NO.	TOTAL NO.
2022CPT.08.16.20762	1d	

THERMOPLASTIC AND PAINT QUANTITIES

PROJECT NO	COUNTY	MAP NO	ROUTE	DESCRIPTION	TYP NO	LANES	LANE TYPE	LENGTH	WIDTH	441300000-E	445700000-N
								MI	FT	WORK ZONE ADVANCE/GENERAL WARNING SIGNING	TEMPORARY TRAFFIC CONTROL
										SF	LS
2022CPT.08.16.20762	Randolph	1	SR 1419 LOWE COUNTRY RD	(FROM: SR 1418 SPENCER MEADOW RD. TO: US HWY 64 W)	1	2	2WU	0.63	20	71	
TOTAL FOR MAP NO. 1								0.63		71	
2022CPT.08.16.20762	Randolph	2	SR 1418 SPENCER MEADOW RD.	(FROM: US HWY 64 W TO: SR 1416 OLD LEXINGTON RD.)	1	2	2WU	1.27	20	143	
TOTAL FOR MAP NO. 2								1.27		143	
2022CPT.08.16.20762	Randolph	3	SR 1493 REFLECTION LN.	(FROM: SR 1492 HARMONY TRL. TO: END-OF-CUL-DE-SAC)	2	2	2WU	0.05	20	6	
TOTAL FOR MAP NO. 3								0.05		6	
2022CPT.08.16.20762	Randolph	4	SR 1492 HARMONY TRAIL	(FROM:SR 1418 SPENCER MEADOW RD. TO: END OF CUL-DE-SAC)	2	2	2WU	0.16	20	18	
TOTAL FOR MAP NO. 4								0.16		18	
2022CPT.08.16.20762	Randolph	5	SR 1494 TRANQUIL LN.	(FROM:SR 1418 SPENCER MEADOW RD. TO: END OF CUL-DE-SAC)	2	2	2WU	0.19	21	22	
TOTAL FOR MAP NO. 5								0.19		22	
2022CPT.08.16.20762	Randolph	6	SR 3144 BENTON RD.	(FROM:SR 1518 PLAINFIELD RD. TO: END OF MAINTENANCE)	2	2	2WU	0.23	18	68	
TOTAL FOR MAP NO. 6								0.23		68	
2022CPT.08.16.20762	Randolph	7	SR 1514 OLD WAY RD.	(FROM: END-OF-STATE MAINTENANCE TO: SR 1518 PLAINFIELD RD.)	2	2	2WU	0.31	20	35	
TOTAL FOR MAP NO. 7								0.31		35	
2022CPT.08.16.20762	Randolph	8	SR 3225 SYLVAN WAY	(FROM: SR 1518 LAKE LUCAS RD. TO: END-OF-CUL-DE-SAC)	2	2	2WU	0.25	20	28	
TOTAL FOR MAP NO. 8								0.25		28	
2022CPT.08.16.20762	Randolph	9	SR 3226 BLUEBIRD LN.	(FROM:SR 3225 SYLVAN WAY TO: END OF CUL-DE-SAC)	2	2	2WU	0.16	20	18	
TOTAL FOR MAP NO. 9								0.16		18	
2022CPT.08.16.20762	Randolph	10	SR 2120 CAMP NAWAKA RD.	(FROM:SR 2119 NAOMI RD. TO:END OF MAINTENANCE)	2	2	2WU	0.31	20	35	
TOTAL FOR MAP NO. 10								0.31		35	
2022CPT.08.16.20762	Randolph	11	SR 2328 LAUREL LN.	(FROM:SR2120 CAMP NAWAKA RD. TO:END OF MAINTENANCE)	2	2	2WU	0.09	20	11	
TOTAL FOR MAP NO. 11								0.09		11	
2022CPT.08.16.20762	Randolph	12	SR 2828 MILES MOFFITT RD.	FROM NC 42 TO END OF MAINTENANCE	2	2	2WU	0.84	20	95	
TOTAL FOR MAP NO. 12								0.84		95	
2022CPT.08.16.20762	Randolph	13	SR 2986 KEN LEE CT.	(FROM:SR 2828 MILES MOFFITT RD. TO: END OF CUL-DE-SAC)	2	2	2WU	0.2	20	23	
TOTAL FOR MAP NO. 13								0.2		23	
2022CPT.08.16.20762	Randolph	14	SR 1206 CANNON HEIGHTS DR.	(FROM:SR 1144 MACK RD.TO: END OF CUL-DE-SAC)	2	2	2WU	0.19	20	22	
TOTAL FOR MAP NO. 14								0.19		22	
2022CPT.08.16.20762	Randolph	15	SR 1252 SOUTHMONT HEIGHTS AVE.	(FROM:SR 1206 CANNON HEIGHTS DR. TO:END OF MAINTENANCE)	2	2	2WU	0.13	20	14	
TOTAL FOR MAP NO. 15								0.13		14	

							PROJECT NO.	SHEET NO.	TOTAL NO.	
							2022CPT.08.16.20762	1e		
2022CPT.08.16.20762	Randolph	16	SR 1253 MONTLEY VIEW DR.	(FROM:SR 1252 SOUTHMONT HEIGHTS AVE. TO: END OF MAINTENANCE)	2	2	2WU	0.13	20	15
TOTAL FOR MAP NO. 16								0.13		15
2022CPT.08.16.20762	Randolph	17	SR 3002 FAITH MEADOWS LN.	(FROM: NC159 TO: END OF CUL-DE-SAC)	2	2	2WU	0.26	20	30
TOTAL FOR MAP NO. 17								0.26		30
2022CPT.08.16.20762	Randolph	18	SR 2978 NORTH POINTE DR.	(FROM:SR 2976 TWIN CREEK RD. TO: END-OF-MAINTENANCE)	2	2	2WU	0.14	20	16
TOTAL FOR MAP NO. 18								0.14		16
2022CPT.08.16.20762	Randolph	19	SR 2976 TWIN CREEK RD.	(FROM: NC-159 TO: END OF CUL-DE-SAC)	2	2	2WU	0.28	20	32
TOTAL FOR MAP NO. 19								0.28		32
2022CPT.08.16.20762	Randolph	20	SR 2993 WILLOW DOWNS CT.	(FROM: NC 159 TO: END OF CUL-DE-SAC)	2	2	2WU	0.2	20	23
TOTAL FOR MAP NO. 20								0.2		23
2022CPT.08.16.20762	Randolph	21	SR 3117 DOGWOOD TRL.	(FROM: SR 1408 HOOVER HILL RD. TO: SR 3116 FOREST LAKE DR.)	2	2	2WU	0.34	20	23
TOTAL FOR MAP NO. 21								0.34		23
2022CPT.08.16.20762	Randolph	22	SR 3116 FOREST LAKE DR.	(FROM: SR 3115 RED FOX TRL. TO: SR 3117 DOGWOOD TRL.)	2	2	2WU	0.18	20	21
TOTAL FOR MAP NO. 22								0.18		21
2022CPT.08.16.20762	Randolph	23	SR 3115 RED FOX TRL.	(FROM: SR1408 HOOVER HILL RD. TO: SR3116 FOREST LAKE DR.)	2	2	2WU	0.35	20	40
TOTAL FOR MAP NO. 23								0.35		40
2022CPT.08.16.20762	Randolph	24	SR 1434 DANWOOD ST.	(FROM: SR 3255 OLD FARMER RD. TO: SR 1433 BUNTING RD.)	2	2	2WU	0.35	20	40
TOTAL FOR MAP NO. 24								0.35		40
2022CPT.08.16.20762	Randolph	25	SR 1436 RUSHWOOD RD.	(FROM: SR 3255 OLD FARMER RD. TO: SR 1435 HIGHRIDGE ST.)	2	2	2WU	0.17	20	20
TOTAL FOR MAP NO. 25								0.17		20
2022CPT.08.16.20762	Randolph	26	SR 1435 HIGHRIDGE ST.	(FROM: SR 1437 RUSSELL ST. TO: END OF MAINTENANCE)	2	2	2WU	0.18	20	20
TOTAL FOR MAP NO. 26								0.18		20
2022CPT.08.16.20762	Randolph	27	SR 1433 BUNTING RD.	(FROM: SR 3255 OLD FARMER RD. TO: END OF MAINTENANCE)	2	2	2WU	0.9	20	20
TOTAL FOR MAP NO. 27								0.9		20
2022CPT.08.16.20762	Randolph	28	SR 1437 RUSSELL ST.	(FROM: SR 1434 DANWOOD RD. TO: END OF MAINTENANCE)	2	2	2WU	0.14	20	20
TOTAL FOR MAP NO. 28								0.14		20
2022CPT.08.16.20762	Randolph	29	SR 1438 NORMAN ST.	(FROM: SR 1437 RUSSELL ST. TO: END OF MAINTENANCE)	2	2	2WU	0.11	20	20
TOTAL FOR MAP NO. 29								0.11		20
2022CPT.08.16.20762	Randolph	30	SR 1439 HAMILTON ST.	(FROM: SR 1438 NORMAN ST. TO END OF MAINTENANCE)	2	2	2WU	0.03	20	20
TOTAL FOR MAP NO. 30								0.03		20
2022CPT.08.16.20762	Randolph	31	SR 2408 BROWNS MEADOW RD.	(FROM: SR 1006 OLD 421 RD. TO: US HWY 421)	1	2	2WU	1.43	20	161
TOTAL FOR MAP NO. 31								1.43		161
2022CPT.08.16.20762	Randolph	32	SR 2408 BROWNS MEADOW RD.	(FROM: US HWY 421 TO: SR 2407 SHILOH RD)	1	2	2WU	0.26	20	30
TOTAL FOR MAP NO. 32								0.26		30
2022CPT.08.16.20762	Randolph	33	SR 2108 WAYNE WHITE RD	(FROM: SR 2116 NEW SALEM RD. TO: SR 2106 RACINE RD.)	1	2	2WU	3.11	20	350
TOTAL FOR MAP NO. 33								3.11		350
2022CPT.08.16.20762	Randolph	34	SR 2104 HOCKETT COUNTRY LN.	(FROM: GUILFORD COUNTY LINE. TO: SR 2103 WHITT HUNT RD.)	2	2	2WU	0.49	20	55

										PROJECT NO.	SHEET NO.	TOTAL NO.
										2022CPT.08.16.20762	1f	
TOTAL FOR MAP NO. 34										0.49		55
2022CPT.08.16.20762	Randolph	35	SR 2360 TAYLOR WOODS LN.	(FROM: SR 2104 HOCKETT CTRY LN. TO: END OF CUL-DE-SAC)	2	2	2WU	0.23	20	26		
TOTAL FOR MAP NO. 35										0.23		26
2022CPT.08.16.20762	Randolph	36	SR 2375 RAYLE FARM RD.	(FROM: SR 2360 TAYLOR WOODS LN. TO: SR 2103 WHITT HUNT RD.)	2	2	2WU	0.58	20	65		
TOTAL FOR MAP NO. 36										0.58		65
2022CPT.08.16.20762	Randolph	37	SR 2102 BANTAM RD.	(FROM: GUILFORD COUNTY LINE. TO: SR 2101 BRANSON MILL RD.)	1	2	2WU	1.48	20	65		
TOTAL FOR MAP NO. 37										1.48		65
2022CPT.08.16.20762	Randolph	38	SR 1306 RICHEY RD.	(FROM: SR 1303 BRANTLEY GORDON RD. TO: SR 1001 FARMER DENTON RD.)	1	2	2WU	1.88	20	211		
TOTAL FOR MAP NO. 38										1.88		211
2022CPT.08.16.20762	Randolph	39	SR 1314 WOODS DAIRY RD / JACKSON CREEK RD.	(FROM: DAVIDSON COUNTY TO: SR 1311 BESCHER CHAPEL RD.)	1	2	2WU	3.46	20	388		
TOTAL FOR MAP NO. 39										3.46		388
2022CPT.08.16.20762	Randolph	40	SR 1343 CHAPELWOOD RD.	(FROM: SR 1314 WOODS DAIRY RD. TO: END OF MAINTENANCE)	1	2	2WU	0.5	20	34		
TOTAL FOR MAP NO. 40										0.5		34
2022CPT.08.16.20762	Randolph	41	SR 1341 LOFLIN HILL RD.	(FROM: SR 1340 SUMMEY TOWN RD. TO: SR 1339 ROSS WOOD RD.)	1	2	2WU	1.94	20	218		
TOTAL FOR MAP NO. 41										1.94		218
2022CPT.08.16.20762	Randolph	42	SR 1317 GOLDEN MEADOW RD.	(FROM: SR 1314 JACKSON CREEEK RD. TO: SR 1318 MOORE RD.)	1	2	2WU	1.84	20	207		
TOTAL FOR MAP NO. 42										1.84		207
2022CPT.08.16.20762	Randolph	43	SR 2376 RAYLE FARM CT.	(FROM: SR 2375 RAYLE FARM RD. TO: END OF MAINTENANCE)	2	2	2WU	0.13	20	15	*	
TOTAL FOR MAP NO. 43										0.13		15
TOTAL FOR PROJ NO. 2022CPT.08.16.20762										26.1		2,794
GRAND TOTAL										26.1		2,794

Maps 31,32

Map 33

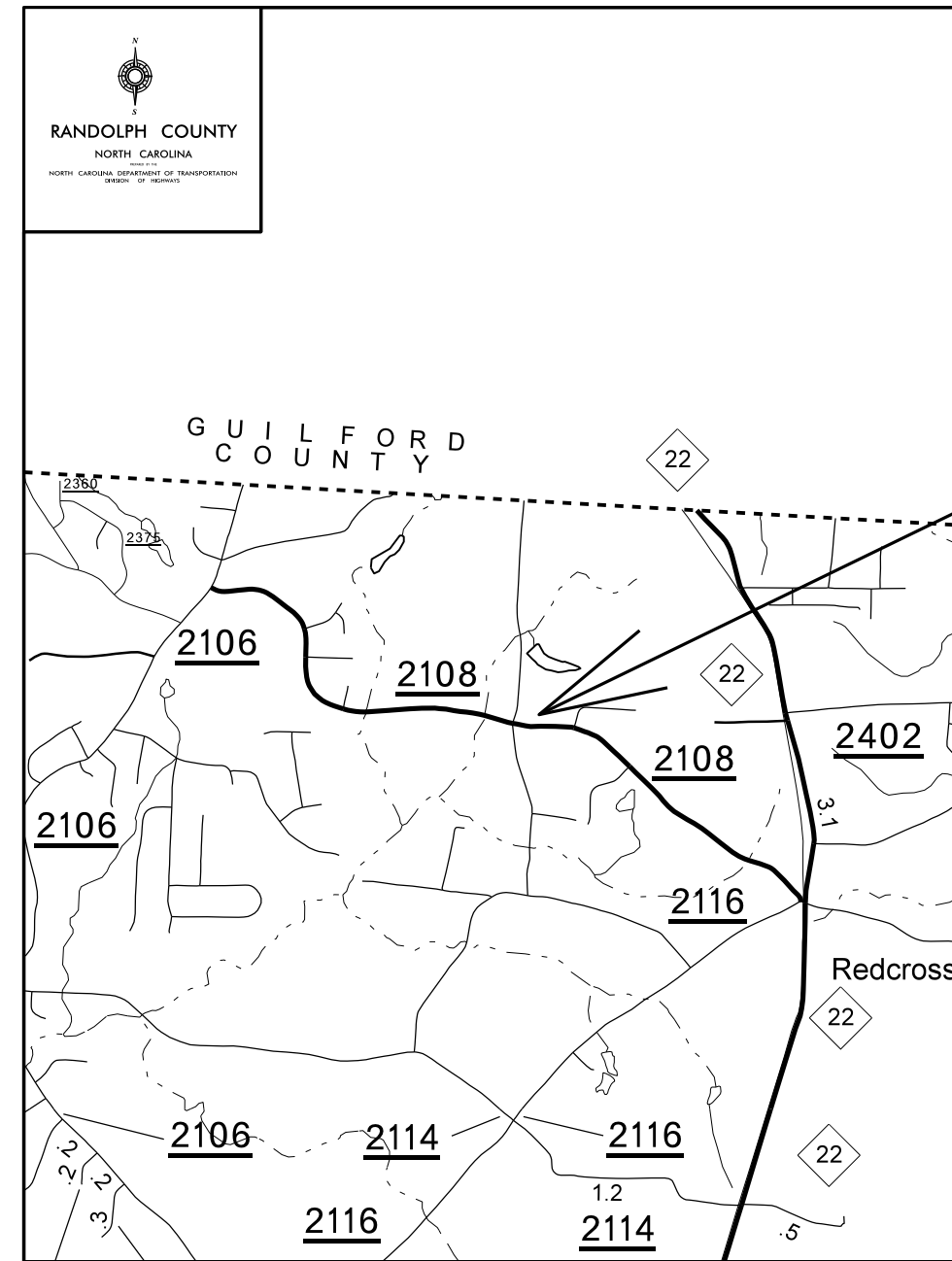
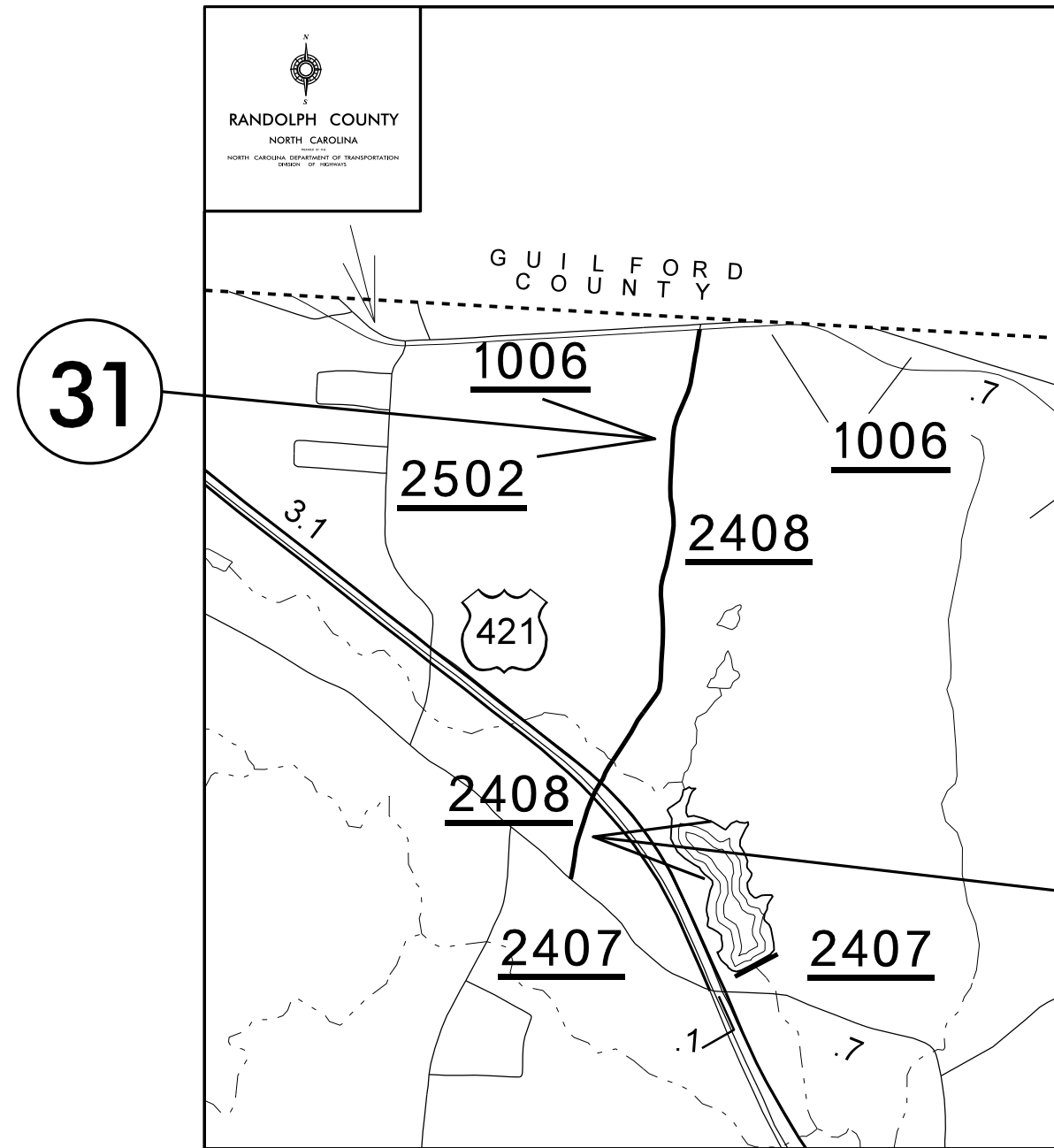

Maps 34,35,36,43

Map 37

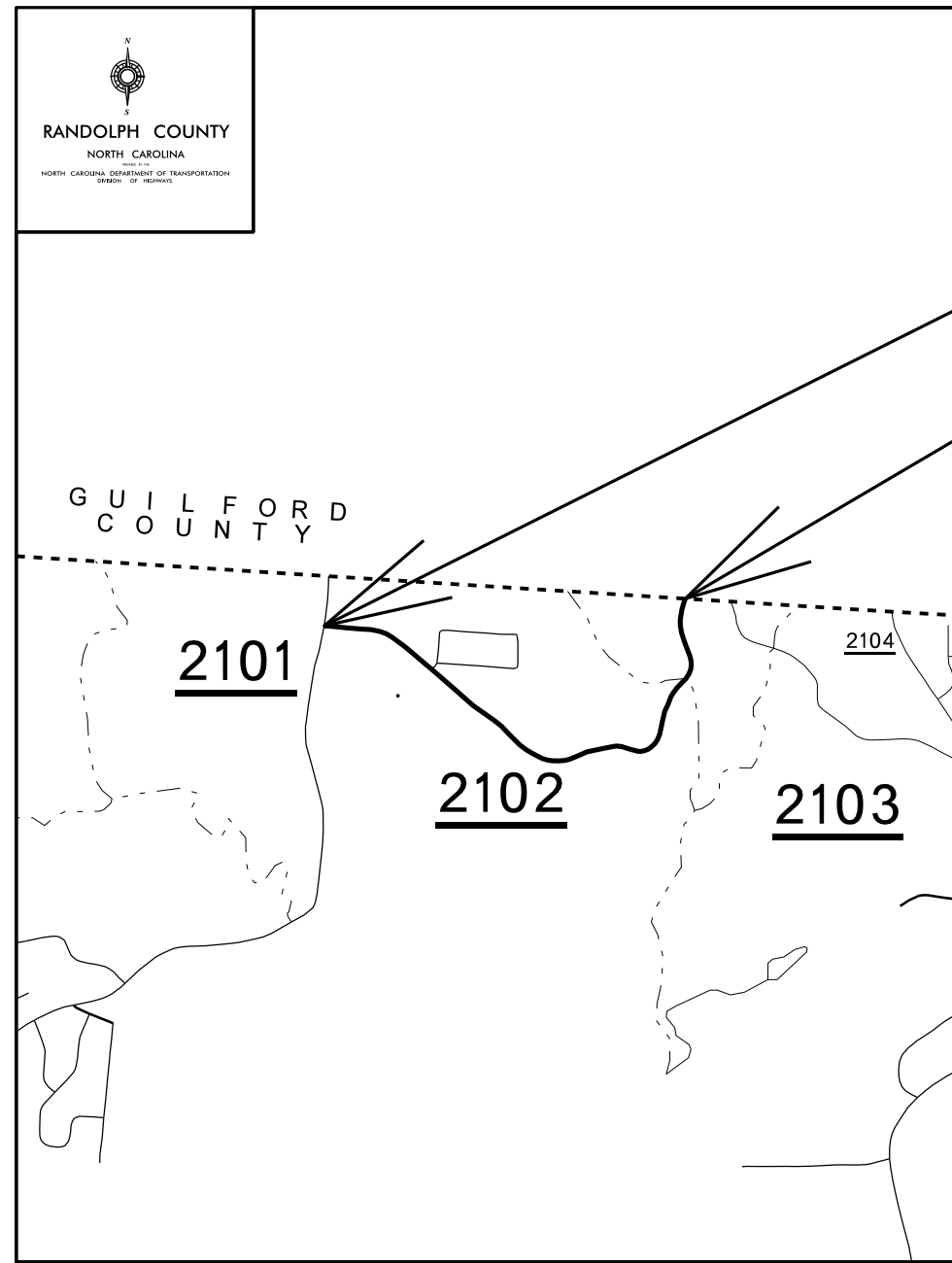
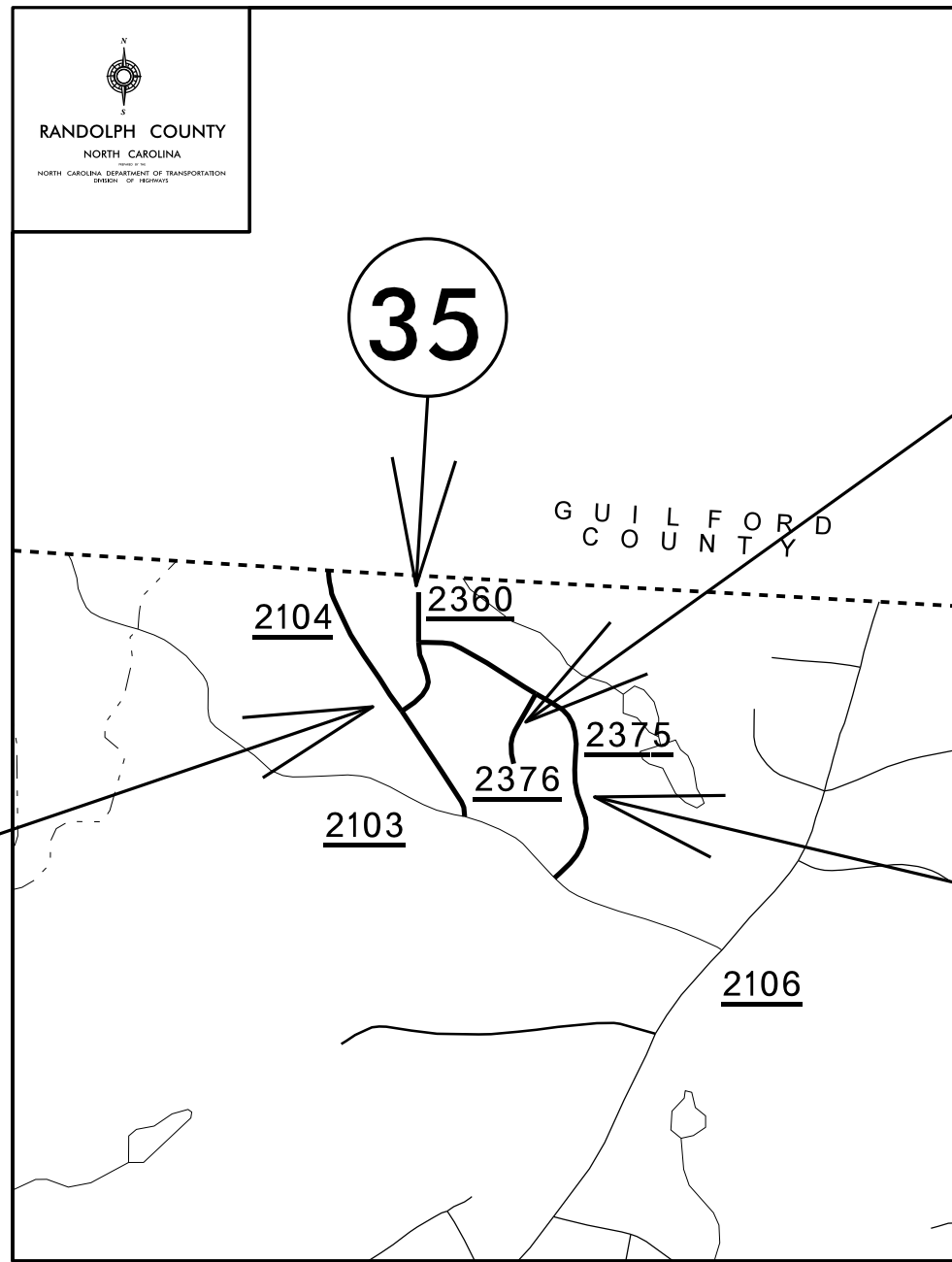

Map 38

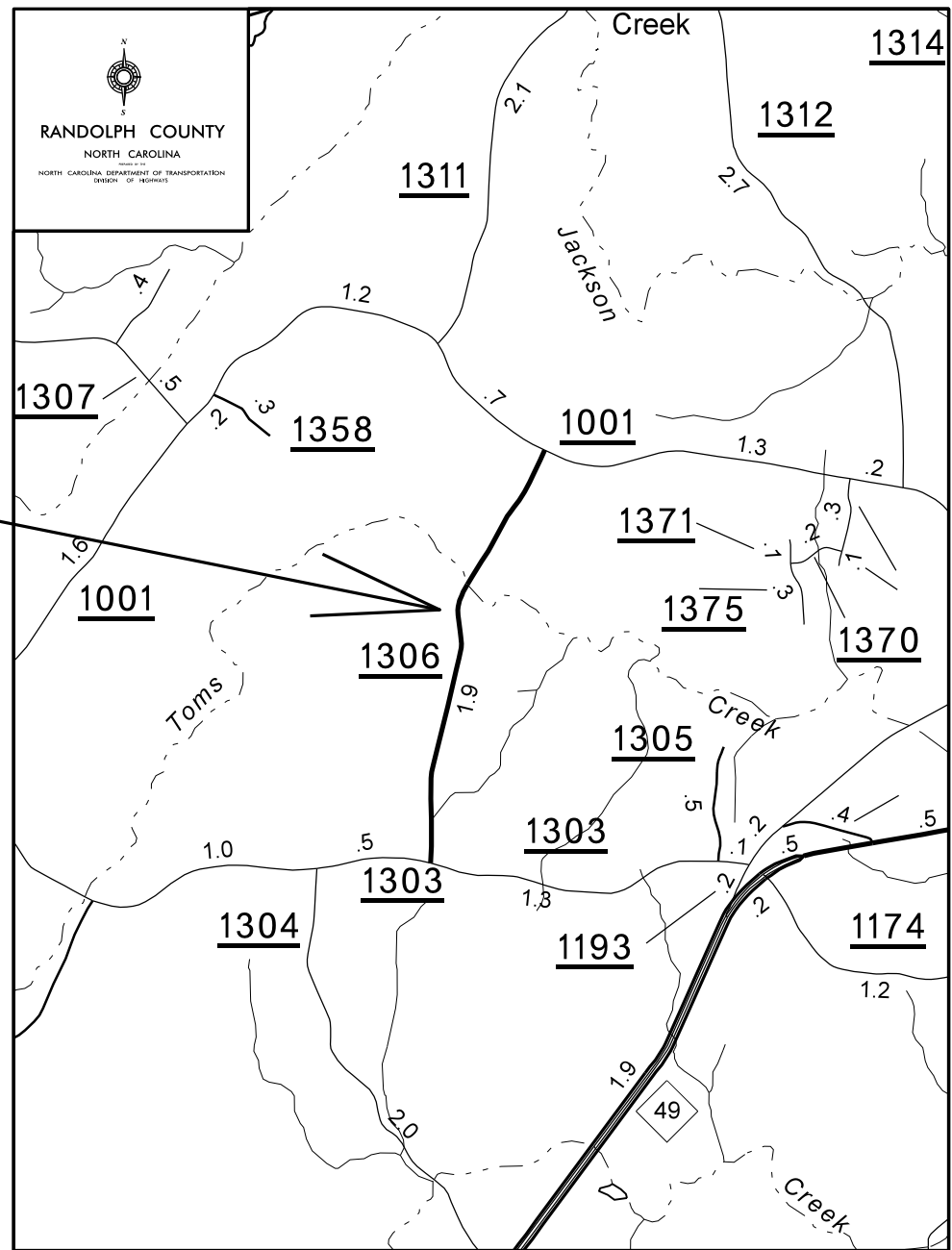

38

Maps 39,40,41

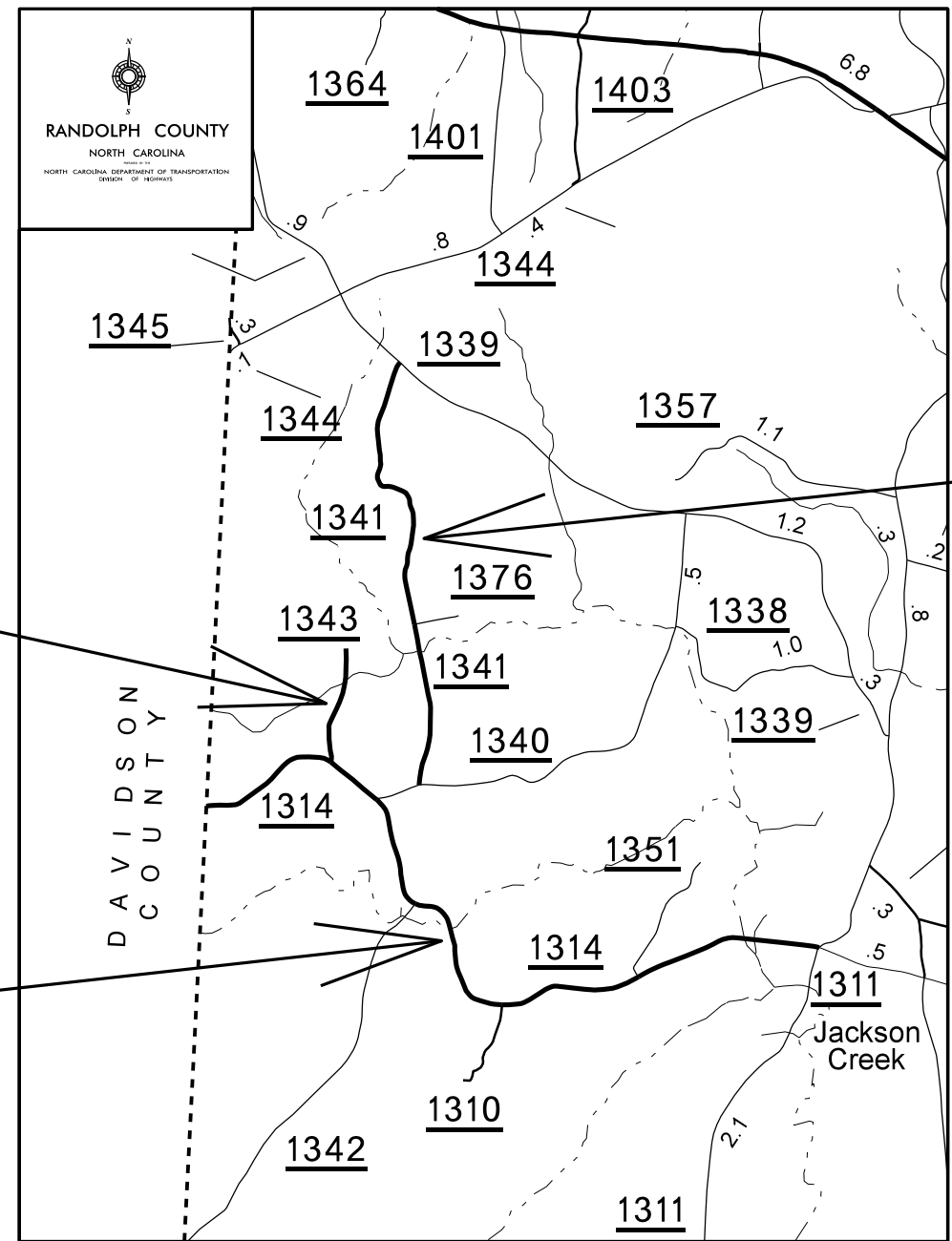

40

41

39

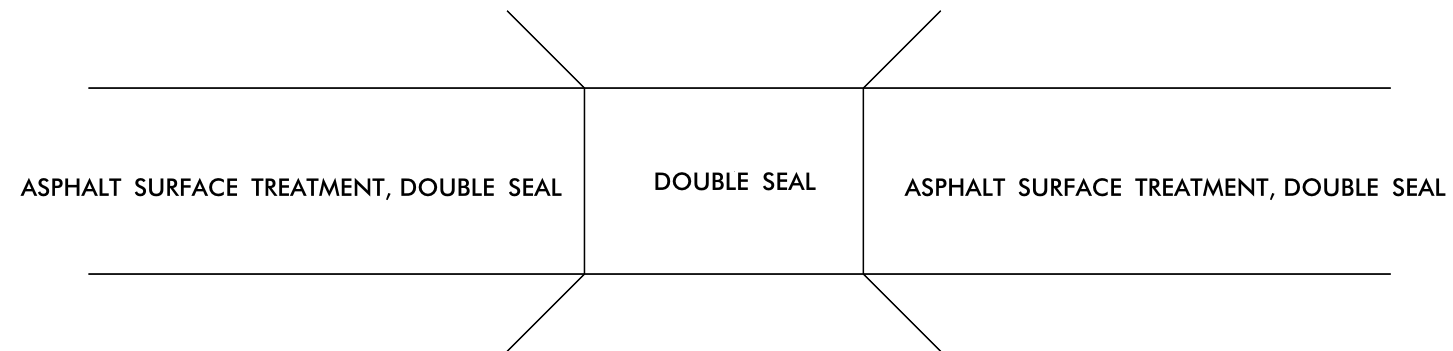

BRIDGE DRAWING FOR
MAP NO 31 SR 2408 BROWNS MEADOW RD BRIDGE #265
MAP NO 38 SR 1306 RICHEY RD BRIDGE #353
MAP NO 42 SR 1317 GOLDEN MEADOW RD BRIDGE #41

DETAILS OF PATCHING EXISTING PAVEMENT PRIOR TO AST

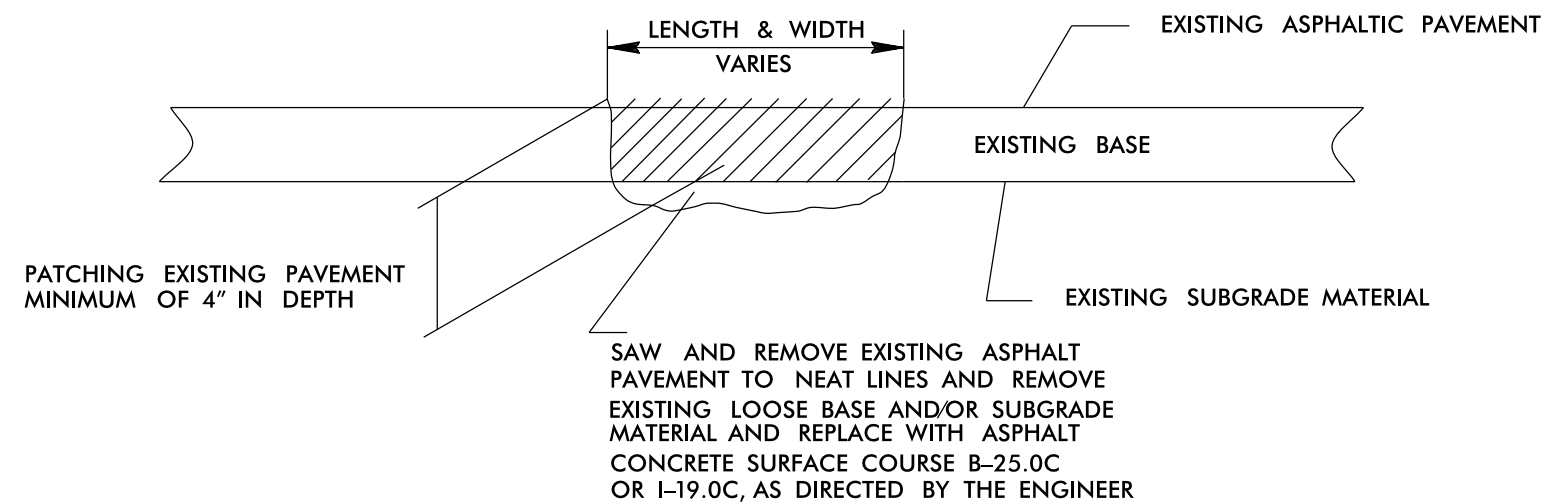

PROJECT NOTES

- FINAL PAVEMENT MARKINGS TO BE HANDLED BY STATE FORCES ON ALL MAPS.

SIGNING FOR ASPHALT SURFACE TREATMENT

LEGEND

- ▷ PORTABLE SIGN
- └ STATIONARY SIGN
- ← DIRECTION OF TRAFFIC FLOW

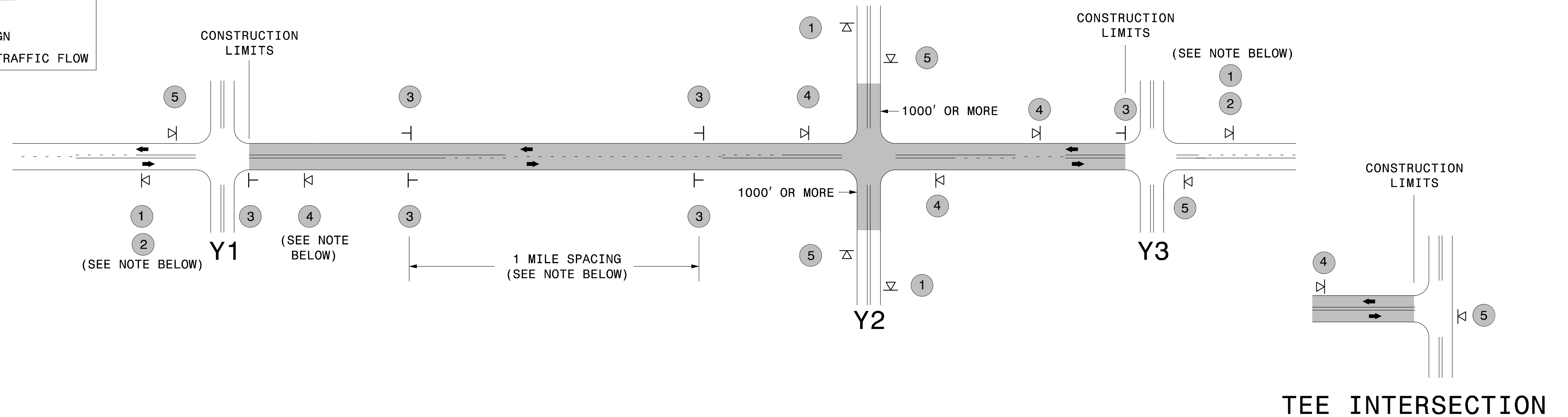

MAINLINE (-L-) SIGNING

-Y- LINE SIGNING

SIGNING NOTES AND PLACEMENT PER DIRECTION	1		- PLACE 1000' PRIOR TO BEGINNING OF CONSTRUCTION LIMITS. ONLY USED ON -Y- LINES IF RESURFACING LIMITS EXTEND 1000' ALONG -Y- LINE.	<p>STATIONARY SIGNING NOT REQUIRED FOR THE FOLLOWING -Y- LINE CONDITIONS:</p> <ol style="list-style-type: none"> 1) LESS THAN 1000' OF RESURFACING ALONG -Y- LINE 2) SUBDIVISION ROADS 3) DEAD END ROADS <p>WHEN PAVING/CONSTRUCTION ACTIVITIES PROCEED ACROSS AN UNSIGNED -Y- LINE, PORTABLE ADVANCE WARNING SIGNS SHALL BE USED ALONG THE -Y- LINE AS SHOWN BELOW. REMOVE UPON COMPLETION OF WORK.</p> <div style="display: flex; justify-content: space-around;"> <div style="text-align: center;"> W20-1 48" X 48" PLACED 500' IN ADVANCE OF FLAGGER. </div> <div style="text-align: center;"> W20-7 A 48" X 48" PLACED 250' IN ADVANCE OF FLAGGER. </div> </div>
	2		- SIGN #2 ONLY USED WHEN RESURFACING LIMITS ARE 2 OR MORE MILES IN LENGTH. ROUND UP TO THE NEAREST WHOLE NUMBER. DO NOT USE FRACTIONAL OR DECIMAL NUMBERS.	
	3	 	- ALTERNATE THE FOLLOWING TWO SIGNS: - STARTING WITH "LOOSE GRAVEL" (W8-7) FOLLOWED BY "UNMARKED PAVEMENT". - PLACE INITIALLY AT THE CONSTRUCTION LIMITS AND SPACED 1 MILE APART THEREAFTER. - AT TEE INTERSECTIONS INSTALL INITIALLY 0.5 MILE FROM INTERSECTION AND SPACE 1 MILE APART THEREAFTER.	
	4		- THESE ARE FOR -Y- LINES THAT ARE "THROUGH" ROADWAYS. DEAD END AND SUBDIVISION ROADS ARE NOT "THROUGH" ROADWAYS. - INSTALL 500' +/- FROM EACH -Y- LINE APPROACH AS SHOWN ABOVE. - FOR MULTIPLE -Y- LINES THAT ARE SEPARATED BY 0.25 MILES OR LESS, TREAT AS A SINGLE UNIT AND INSTALL WITHIN 500' OF EACH APPROACH. - A MAXIMUM OF 2 SIGN SETS PER MILE. DO NOT INSTALL WHEN -Y- LINES ARE WITHIN 0.5 MILES FROM "END ROAD WORK" SIGN.	
	5		PLACE 500' FOLLOWING THE END OF CONSTRUCTION LIMITS OR AS SHOWN WHEN WORK ENDS AT A 3-WAY TEE INTERSECTION.	

THE ABOVE SIGNS ARE ALL THAT ARE REQUIRED FOR A CONTRACTOR TO BEGIN A RESURFACING CONTRACT. ANY ADDITIONAL SIGNS REQUESTED BY NCDOT DIVISIONS SHALL BE INSTALLED WITHIN 7 BUSINESS DAYS OF THE START OF CONTRACT WORK.

MAPS LESS THAN 2 MILES

FOR AST RESURFACING MAPS WITH CONSTRUCTION LIMITS LESS THAN 2 MILES IN LENGTH, USE A STATIONARY "LOOSE GRAVEL" SIGN AT THE BEGINNING CONSTRUCTION LIMIT FOLLOWED BY AN "UNMARKED PAVEMENT" SIGN MIDWAY THROUGH AND AN "END ROAD WORK" SIGN AT THE END CONSTRUCTION LIMIT.

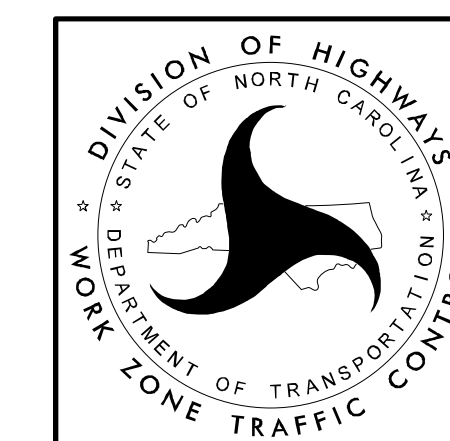

ADVANCE WARNING SIGNS FOR 2-LANE ROADWAY ASPHALT SURFACE TREATMENT